

Battery Pack – Lithium Polymer (Li-Po) 3.7Vdc; 400mAh; 1.4Wh

THE BATTERY PACK MUST BE DISPOSED OF THROUGH RECOGNISED DISPOSAL ROUTES

WARNING

- DO NOT ATTEMPT TO DISASSEMBLE, OPEN OR SERVICE THE BATTERY PACK
- DO NOT CRUSH, PUNCTURE OR DISPOSE OF IN FIRE OR WATER
- DO NOT SHORT EXTERNAL CONTACTS

PA160122E



EN. Please read the information sheet before proceeding.

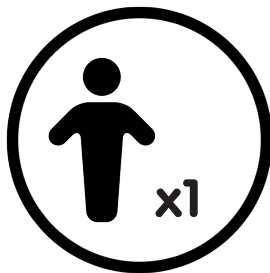

Please read all of the information carefully and refer back when you see the numbered icons throughout instructions.

Safety and Care (EN)

- 1 To retain the best quality finish, clean product regularly with a soft damp cloth.
- 2 Do not use abrasive or chemical cleaners, as these will damage the product.
- 3 Do not immerse in water or place directly under running water.
- 4 Only fix to flat, shiny, glazed tiles or glass. Never use on wood, painted, matte or textured surfaces.
- 5 Do not position sucker over grout lines. Not suitable for marble tiles.

Before installing

1. Thoroughly clean the mounting surface to remove any dirt, residue or contaminants that may reduce the sucker performance.
2. Rinse the mounting surface with clean water and dry with a clean cloth.
3. Rinse suction bracket in warm water to remove any dust etc. that may have accumulated since manufacture, then dry with a clean cloth.



 Croydex, Central Way, Andover, Hampshire, SP10 5AW, UK

 +44 (0) 1264 365881

 +44 (0) 1264 356437

 info@croydex.co.uk

 www.croydex.com

S&H 069 R04

1.

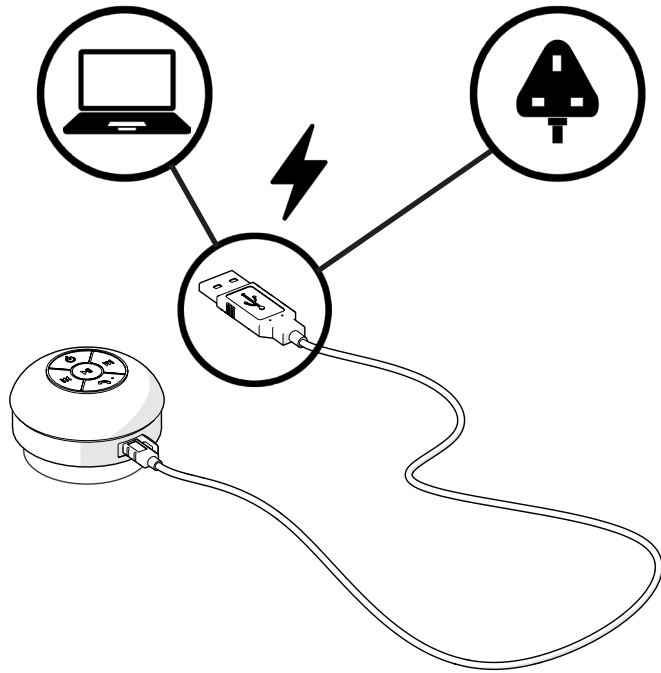

2.

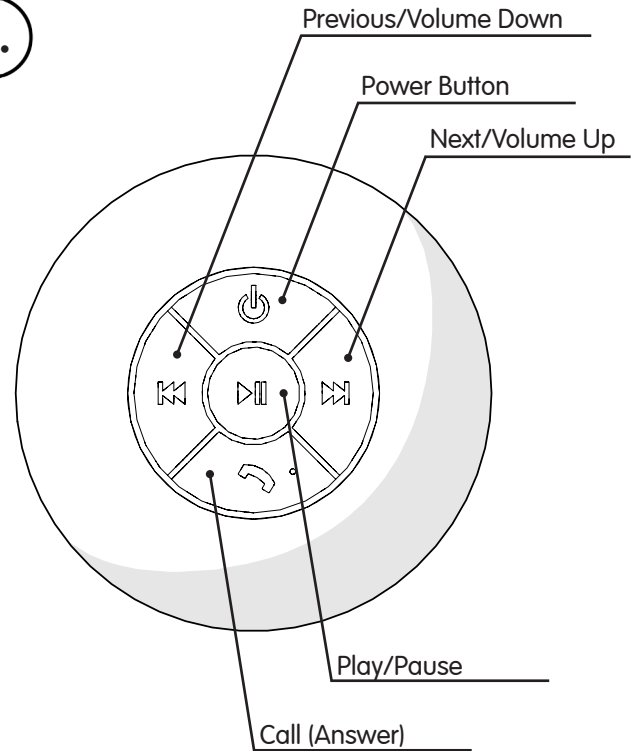

LED Indicator

Blue LED flashing quickly indicates pairing mode.
 Blue LED flashing slowly indicates successful pairing.
 Solid Red LED indicates device is charging.
 Flashing Red LED indicates low battery.
 Red LED turns off when fully charged.

3.

How it works

Press and hold the power button to start up the device. A light will appear to confirm it is on.

To pair your device to the speaker please turn on your devices bluetooth function and search for **CDX SHOWER SPKR.**

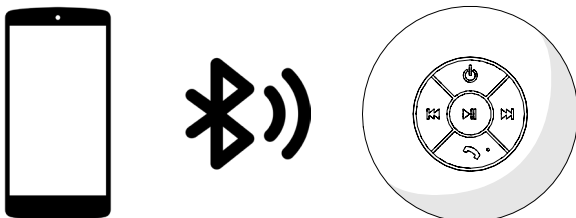

The power light will flash to tell you it is searching. You will hear a chime to confirm you have paired your devices successfully.

Once paired you can play music or receive phone calls through your device.

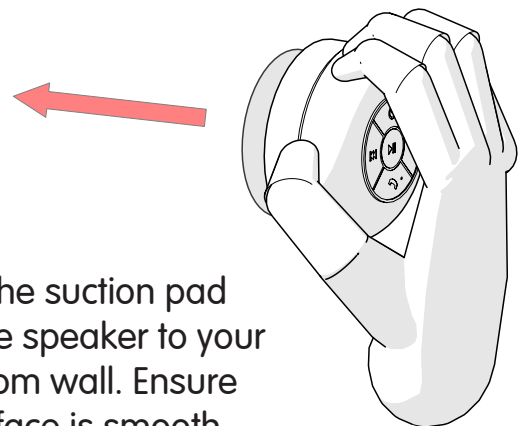

Using the suction pad stick the speaker to your bathroom wall. Ensure the surface is smooth and free from debris.

Accepting calls

To accept a call in the shower press the Call button once and talk into the speaker.

Press the call button once more to end the conversation.

2.

Croydex, Central Way, Andover, Hampshire, SP10 5AW, UK

+44 (0) 1264 356437

www.croydex.com

+44 (0) 1264 365881

info@croydex.co.uk

S&H 069 R04



To the Radio Equipment Directive (2014/53/EU) and the Electromagnetic Compatibility (EMC) Directive (2014/30/EU)

1. *Description of product:-*

Name: **Bluetooth Speaker**
Part No. **PA160122E**

2. *Directive complied with:-*

European Parliament/Council Directive 2014/30/EU on the harmonisation of the laws of the Member States relating to electromagnetic compatibility (EMC) Directive (recast).

3. *Declaration*

The product listed above in section 1 conform to the following harmonised standards:

ETSI EN 301 489-1 V1.9.2 (2011-09)
ETSI EN 301 489-17 V2.1.1 (2009-05)
ETSI EN 300 328 V1.8.1 (2012-04)
BS EN 62479:2010
BS EN 62368-1:2014

For and on behalf of CROYDEX



P. Pegden
Product and Procurement Director
Date: 04-12-2016



To the Restriction of Hazardous Substances (RoHS) Directive 2011/65/EU

1. *Description of products:-*

Name: **Bluetooth Speaker**
Part No. **PA160122E**

2. *Directives complied with:-*

European Council Directive 2011/65/EU of 8 June 2011 on the restriction of the use of certain hazardous substances in electrical and electronic equipment (recast).

3. *Declaration*

It is hereby certified that the concentration by weight of the restricted substances in the homogenous materials in the products described above at section 1 do not exceed the maximum allowed concentrations listed in European Council Directive 2011/65/EU Annex II Restricted substances referred to in Article 4(1) and maximum concentration values tolerated by weight in homogeneous materials, as detailed below:

Substance	Concentration
Lead	0.1%
Mercury	0.1%
Cadmium	0.01%
Hexavalent Chromium	0.1%
PBB (Polybrominated Biphenyls)	0.1%
PBDE (Polybrominated Diphenyl Ethers)	0.1%

For and on behalf of CROYDEX

P. Pegden
Product and Procurement Director
Date: 04-12-2016